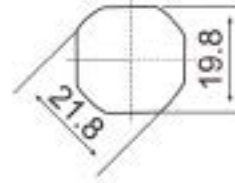
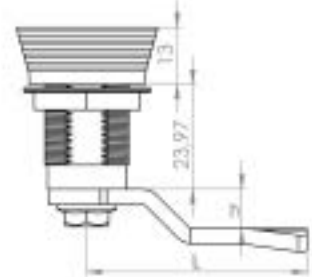
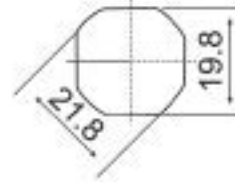

Yaylı Pano Kilidi
Quarter Turn Whit Spring
308-5

Malzeme
 Kovan: Zamak - DIN - EN 1774-ZnAl4Cu1
 Dil: Çelik
 Conta: Kauçuk
 Yüzey: Krom
Material
 Housing: Zamak - DIN-EN 1774-ZnAl4Cu1
 Cam: Steel
 Gasket: Rubber
 Finish: Chrome

Dil Kodu / Cam Code	h	L
01	0	50
02	5	48

Yaylı Pano Kilidi
Quarter Turn Whit Spring
308-6

Malzeme
 Kovan: Zamak - DIN - EN 1774-ZnAl4Cu1
 Dil: Çelik
 Conta: Kauçuk
 Yüzey: Krom
Material
 Housing: Zamak - DIN-EN 1774-ZnAl4Cu1
 Cam: Steel
 Gasket: Rubber
 Finish: Chrome

Dil Kodu / Cam Code	h	L
01	0	50
02	5	48

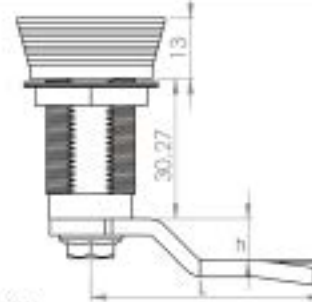
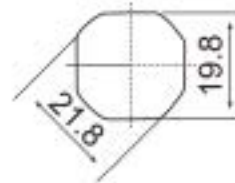
DB-1
U-2
K-3
Yaylı Pano Kilidi (H30)
Quarter Turn Whit Spring
308-7

Malzeme
 Kovan: Zamak - DIN - EN 1774-ZnAl4Cu1
 Dil: Çelik
 Conta: Kauçuk
 Yüzey: Krom
Material
 Housing: Zamak - DIN-EN 1774-ZnAl4Cu1
 Cam: Steel
 Gasket: Rubber
 Finish: Chrome

Dil Kodu / Cam Code	h	L
01	0	50
02	5	48

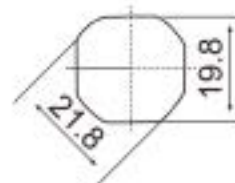
DB-1
U-2
K-3
Yaylı Pano Kilidi
Quarter Turn Whit Spring
308-8

Malzeme
 Kovan: Polyamid DIN-EN ISO 1043-1PAG GRF30
 Dil: Çelik
 Conta: Kauçuk
 Yüzey: Krom
Material
 Housing: Zamak - DIN-EN 1774-ZnAl4Cu1
 Cam: Steel
 Gasket: Rubber
 Finish: Chrome

Dil Kodu / Cam Code	h	L
01	0	50
02	5	48